

**PLANNED TREE MAINTENANCE**

<b>Tree Works Notification</b>		<b>Created By:</b>	
<b>Public Scrutiny</b>		<b>Date:</b>	
<b>Tree Works reference number and schedule title</b>			
<b>Wards included within planned works:</b>			
Abbey		East Chesterton	Queen Ediths
Arbury		Kings Hedges	Romsey
Castle		Market	Trumpington
Cherry Hinton		Newnham	West Chesterton
Coleridge		Petersfield	
<b>Within following Council service areas:</b>			
Highways		Housing	Parks
<b>Size of schedule – based on number of trees included within:</b>			
Small ( < 10 trees)		Medium (11 - 50 trees)	Large ( > 50 trees)
<b>Brief description of the works</b>			

## **Tree Works Notification**

For tree works submitted under a 'Tree Works Notification' I refer you to Policy GM3 of the Cambridge City Council Citywide Tree Strategy 2016-2026 Part 2:

*"All planned tree works will be published on the Council website and through site notices for the community to access at least 20 working days before implementation. The council sees this as an important tool for communicating to the local community about tree work planned for their area and the reasons why the works are necessary."* <https://www.cambridge.gov.uk/tree-strategy>

The notification period will run for 20 days from the date of publication of the schedule.

The majority of the works contained within these schedules consists of minor pruning to address health and safety issues, or more significant works to remove trees that are obviously dead, dying or diseased, or replacement planting for trees that have been removed.

A brief outline of the planned works can be found in the table shown above however; full details of the planned works can be found within the attached schedules and maps.

Please note: where trees are due to be felled, these are marked on site with green tape.

## **Public Scrutiny**

For tree works submitted for 'Public Scrutiny' A brief outline of the planned works which we wish to be publicly scrutinised can be found within the attached schedules and maps which will be available for ten working days following the date of publication.

The planned works could involve either removing healthy trees over 75mm in diameter as measured at 1.5m above ground level and/or any tree work or batch of works that will have a significant impact on the landscape character of an area as assessed by an arboricultural officer. This will include crown reductions of over 30% in branch length on trees that have not previously been reduced.

The table above provides details of the works which are open for public scrutiny, please note that some tree works schedules may contain other works in other service areas than those open to this level of scrutiny. The following details only relate to the significant works considered for scrutiny. Please note: where trees are

due to be felled, these are clearly marked on site with green tape.

I refer you to Policy GM5 of the Cambridge City Council [Citywide Tree Strategy 2016-2026 Part 2](#):

*“When considering tree works on City Council land, the Council will invite resident and stakeholder comment regarding the following kinds of work:*

- a) Any tree work which will have a significant impact on the character of an area.*
- b) Felling healthy trees of over 75mm diameter”*

If you wish to make a comment about any of the works proposed, please submit them via this link: [Comment on a tree work schedule](#). All unresolved objections to tree work subject to public scrutiny will be determined by the relevant Executive Councillor.



Item Ref: 02289

Location:  
Trumpington Recreation Ground

Site type:

Order no/ref:  
Contract/Client Ref:  
Item created: 06 September 2024

Priority of works:  
Start on/after:  
Complete by:

Tree/Item code	Species/Work required	Rate	Quantity	Cost
----------------	-----------------------	------	----------	------

Trumpington Recreation Ground (TRUMPV), Trumpington

Sgl/7 (535680)	Lime (Small Leaved) ( <i>Tilia cordata</i> ) (///wiping.drips.pull) CL2.5 Crown lift to 2.5m		1 tree	
Sgl/22 (535624)	Birch (River) ( <i>Betula nigra</i> ) (///radio.factor.stared) FP Formative prune cut out dead leader RSK REM - stake		1 tree 1 tree	0.00
Sgl/42 (535564)	Birch (Silver) ( <i>Betula pendula</i> ) (///books.notion.shield) RDW Rem - deadwood		1 tree	0.00
Sgl/49 (535552)	Sorbus (Rowan) ( <i>Sorbus aucuparia</i> ) (///adjust.towers.exile) RFR Rem - tree for replant advanced decay at base of trunk		1 tree	0.00
Sgl/54 (535544)	Maple (Sycamore Cv.) ( <i>Acer pseudoplatanus</i> 'Leopoldii') (///month.known.spoken) CLH C/L - over highway to 3.5-4.5m		1 tree	0.00
Sgl/57 (535536)	Maple (Sycamore Cv.) ( <i>Acer pseudoplatanus</i> 'Leopoldii') (///orange.expect.shall) CLH C/L - over highway to 3.5-4.5m RPC Rem - epicormics		1 tree 1 tree	0.00 0.00
Sgl/70 (535512)	Maple (Sycamore Cv.) ( <i>Acer pseudoplatanus</i> 'Leopoldii') (///rides.reform.silly) CLH C/L - over highway to 3.5-4.5m		1 tree	0.00
Sgl/89 (535296)	Prunus (Wild Cherry) ( <i>Prunus avium</i> ) (///puff.reduce.flute) CLH C/L - over highway to 3.5-4.5m		1 tree	0.00
Sgl/90 (535300)	Maple (Sycamore Cv.) ( <i>Acer pseudoplatanus</i> 'Leopoldii') (///belly.grape.pigs) CLH C/L - over highway to 3.5-4.5m		1 tree	0.00
Sgl/99 (535472)	Prunus (Wild Cherry) ( <i>Prunus avium</i> ) (///belt.belong.ranch) RFR Rem - tree for replant dead tree		1 tree	0.00



Item Ref: 02289

Tree/Item code	Species/Work required	Rate	Quantity	Cost
Sgl/101 (535432)	Maple (Field) (Acer campestre) (///bonds.visit.pads)			
	CLH C/L - over highway to 3.5-4.5m		1 tree	0.00
	RPC Rem - epicormics		1 tree	0.00
Sgl/141 (535324)	Maple (Sycamore) (Acer pseudoplatanus) (///larger.army.taped)			
	CL3 Crown lift to 3m		1 tree	
Sgl/142 (535320)	Prunus (Wild Cherry) (Prunus avium) (///putty.tunnel.insert)			
	CL3 Crown lift to 3m		1 tree	
Sgl/143 (535316)	Maple (Sycamore Cv.) (Acer pseudoplatanus 'Leopoldii') (///bottle.spoken.tricky)			
	CL3 Crown lift to 3m		1 tree	
Sgl/144 (535312)	Prunus (Wild Cherry) (Prunus avium) (///wallet.dairy.looked)			
	CL3 Crown lift to 3m		1 tree	
Sgl/148 (535332)	Maple (Sycamore) (Acer pseudoplatanus) (///debit.desire.things)			
	CL3 Crown lift to 3m		1 tree	

Expenditure code analysis :-

Expenditure code not specified

Schedule item analysis :-

CLH	C/L - over highway to 3.5-4.5m	6 trees @ 0.00
RDW	Rem - deadwood	1 tree @ 0.00
RFR	Rem - tree for replant	2 trees @ 0.00
RPC	Rem - epicormics	2 trees @ 0.00
RSK	REM - stake	1 tree @ 0.00

Contractor:

Total cost: 0.00

Issued by:

Kenny McGregeor

Trumpington Recreation Ground (TRUMPV),

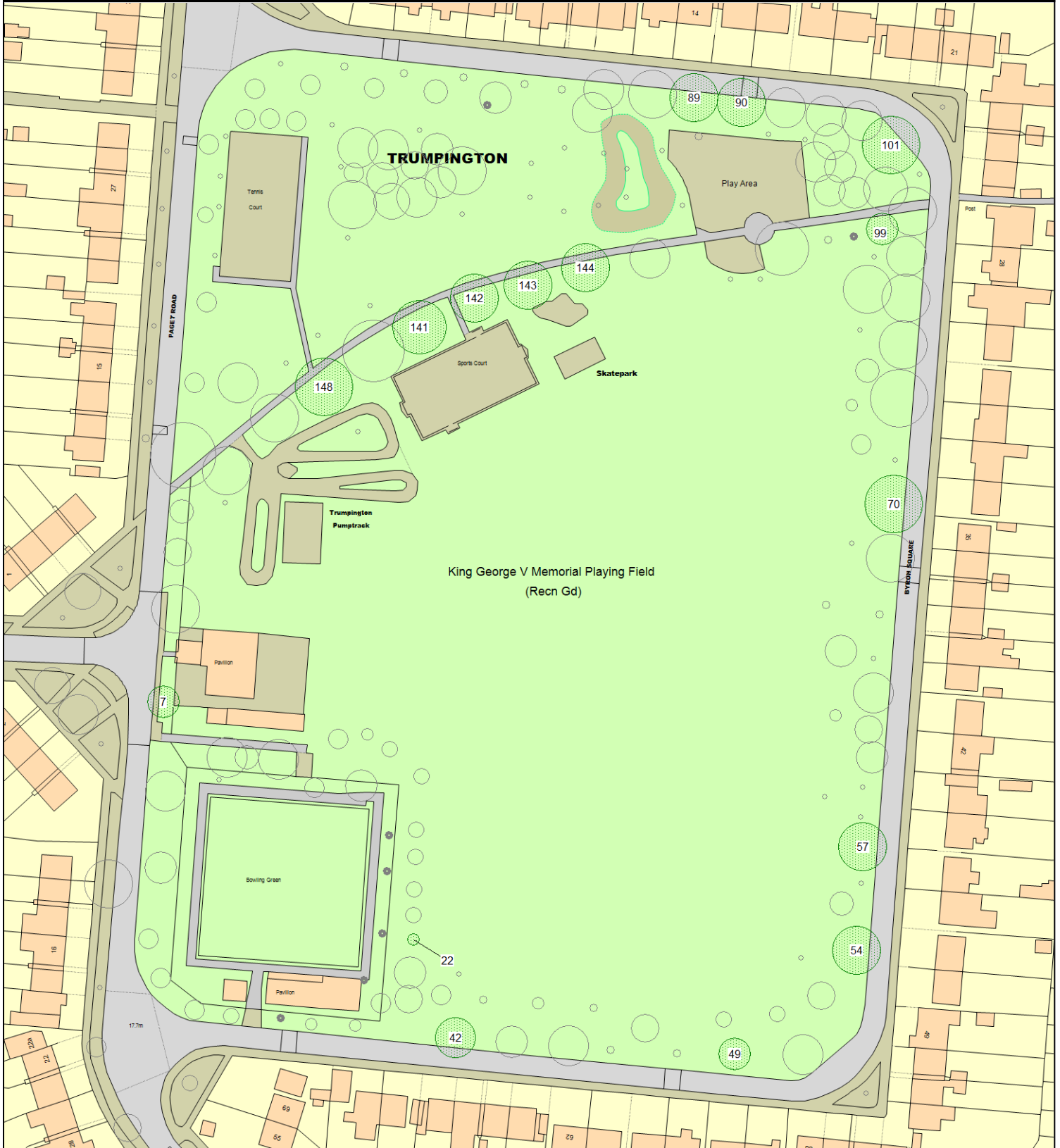

This map is reproduced from Ordnance Survey material with the permission of Her Majesty's Stationery Office (c) Crown copyright. Unauthorised reproduction infringes Crown copyright and may lead to prosecution or civil proceedings." Cambridge City Council (Licence No. 100019730) 2006.